

FORM No. 1.

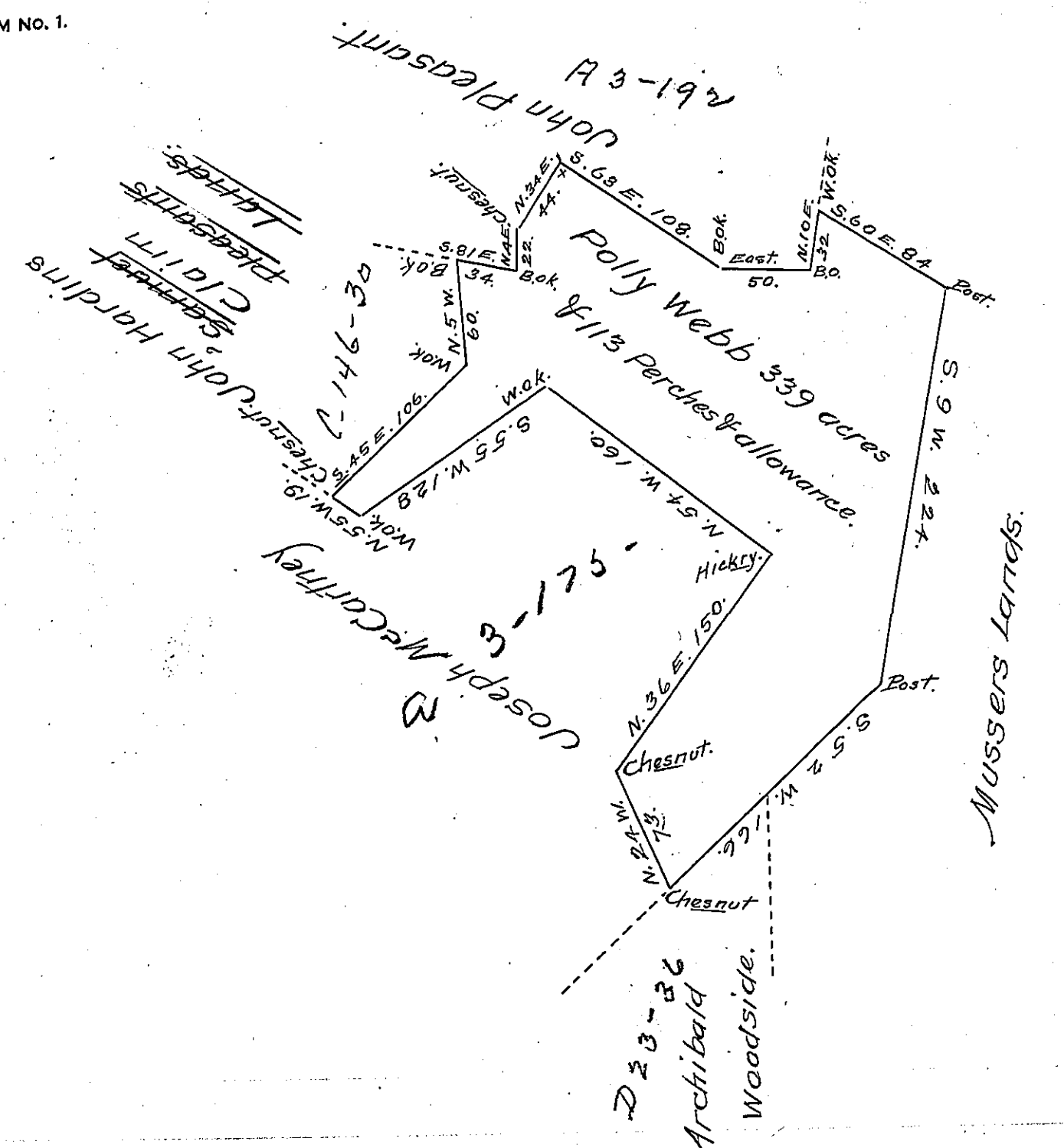

Surveyed to Polly Webb on the 2^d Day of June 1796 the above Described Tract of land containing - Three Hundred and Thirty Nine Acres and one Hundred and thirteen perches and allowance of Six Percent for Roads &c. by or for James Ross Esq^r then Deputy Surveyor which I have Examined and is now correct by Warrant of the 16th June 1794.

Thomas Allison D.S.

Samuel Cochran Esq^r
Surveyor Gen^l.

Wheatfield Township

IN TESTIMONY that the above is a copy of the original remaining on file in the Department of Internal Affairs of Pennsylvania, made conformably to an Act of Assembly approved the 16th day of February 1833, I have hereunto set my hand and caused the Seal of said Department to be affixed at Harrisburg, this eighteenth day of April 1907.

Geo. B. Brown
Secretary of Internal Affairs.